

The services offered by Volcano Spa are complex, serving not merely those who "only" want to relax or swim at a swimming pool but also those, who seek medical, beauty and wellness services.

The Celldömök Volcano Spa – after completing the first and second phases of development – offers extensive services. As a plus service – compared to other spas – the Volcano Spa offers **sophisticated sport possibilities** during winter by utilizing its indoor swimming pool and training pool. Another advantage is its location: the Spa will be popular among those, who prefer a **calm, provincial ambience** instead of busy, overcrowded touristy places. Although having a provincial ambience the city has a **well-developed healthcare infrastructure** (e.g.: hospital) and a **good network of commercial, cultural and technical infrastructural facilities**.

Areas for investment:

1. Celldömök topographical Nr. 0503/8

The Municipality of the City of Celldömök intends to sell an area of **8 hectare** for investment purposes. The area was allocated for the Volcano Spa according of the initial plan and is located at the foot of the "Ság-hill".



There is a 1250 m deep thermal water well and a 200 m deep cold water well on this property. The water quality of both wells has been analyzed. According to the results the **water is very rich in mineral salts** and **very soft**, its characteristic is hydro-carbonate with natrium chloride. The water temperature is 49 °C.

Further areas for utilisation are linked to this property. Close to the property of topographical Nr. 0503/8 is an **area of 39 hectares and 1812 m²** (topographical Nr. 0447/12), which is in undivided joint ownership, the Municipality owning a share of about 10 hectares.

Detailed water component analysis of the thermal well on the realty topographical Nr. 0503/8 (1250 m deep):

Translation of water component analysis

Number of work: 25711/1

Name: Celldömök
Sample: well number 3
Depth: 1250 m

Place of sample:
surface
Water output l/m: 200
Date of sample: 19.10.2001

Cation	mg/l	mg/eél	Than %	Anion	mg/l	mg eél	Than %
Na ⁺	1 120,000	48,700	96,560	NO ₃ ⁻	<1,0	0,000	0,000
K ⁺	5,900	0,150	0,300	NO ₂ ⁻	0,030	0,000	0,000
Li ⁺	0,450	0,060	0,130	Cl ⁻	862,000	24,310	48,180
NH ₄ ⁺	16,000	0,890	1,760	Br ⁻	4,600	0,060	0,110
Ca ²⁺	4,900	0,240	0,480	I ⁻	1,600	0,010	0,020
Mg ²⁺	1,700	0,140	0,280	F ⁻	3,100	0,160	0,320
Fe	4,600	0,250	0,490	SO ₄ ²⁻	<10	0,000	0,000
Mn ²⁺	0,005	0,000	0,000	HCO ₃ ⁻	1 580,000	25,900	51,340
				CO ₃ ²⁻			
				PO ₄ ³⁻	0,250	0,010	0,020
				S ²⁻			
Sum	1 153,600	50,430	100,000		2 541,580	50,450	100,000

Sum of cations and anions: 3 605,000 mg/l

"Free" carbon acid	46,000 mg/l	pHmeasured 8,0	pHbalanced
Bound CO ₂	570,000 mg/l	Corrosion index:	
HBO ₂	8,800 mg/l	m-alkaline	25,900 mmol/l
H ₂ SiO ₃	33,000 SiO ₂ mg/l	p-alkaline	mmol/l
Antimon (Sb)	µg/l	Total hardness	11,000 CaO mg/l
Arsenic (As)	<2 µg/l	Carbonat hardness	11,000 CaO mg/l
Barium (Ba)	390,0 µg/l	not carbonat hardness	0,000 CaO mg/l
Zinc (Zn)	120,000 µg/l	E. conductivity (20°C)	4 090,000 µS/cm
Mercury (Hg)	0,430 µg/l	Rest of condense 180°C	2 750,000 mg/l
Cadmium (Cd)	<0,2 µg/l	Total dissolved minerals	3 540,000 mg/l
Chrome (Cr)	<2 µg/l	KO _{p1}	8,000 O ₂ mg/l
Nickel (Ni)	µg/l	Anionactive detergent	mg/l
Lead (Pb)	6,000 µg/l	Fenolindex	µg/l
Copper (Cu)	<10 µg/l		
Selen (Se)	µg/l		
Cyanide	µg/l	Temperature	46 °C

Physical characteristics: Yellow, slightly oppalic, sedimental

Evaluation:

Basod on the examined components, the water sample is rich in mineral salts, quite soft and has the characteristics of natrium-hydrogen-carbonate, containing chlorid, iodide and fluoride. It is thermal water.

2. Vacant areas around the Volcano Spa

The Municipality of the City of Celldömölk intends to sell its vacant properties around the Volcano Spa for investment purposes. The area covers altogether **9,5 hectares comprising many properties** with different topographical numbers. Making a bid for the whole area, but also parts of it is possible.

The area is intended for **developing commercial and service providing facilities, accommodations**, which would support the activity of the Spa.

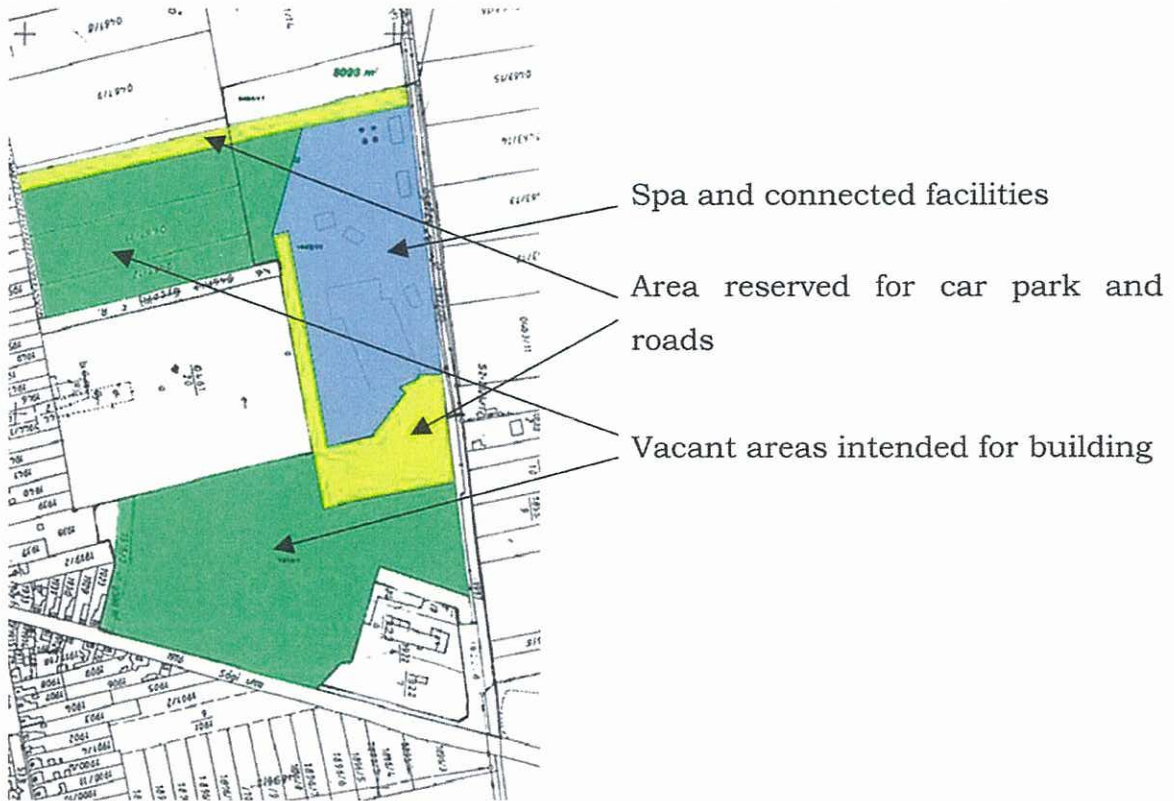



1981
1982
1983
1984
1985
1986
1987
1988
1989
1990
1991
1992
1993
1994
1995
1996
1997
1998
1999
2000
2001
2002
2003
2004
2005
2006
2007
2008
2009
2010
2011
2012
2013
2014
2015
2016
2017
2018
2019
2020
2021
2022
2023
2024
2025
2026
2027
2028
2029
2030
2031
2032
2033
2034
2035
2036
2037
2038
2039
2040
2041
2042
2043
2044
2045
2046
2047
2048
2049
2050
2051
2052
2053
2054
2055
2056
2057
2058
2059
2060
2061
2062
2063
2064
2065
2066
2067
2068
2069
2070
2071
2072
2073
2074
2075
2076
2077
2078
2079
2080
2081
2082
2083
2084
2085
2086
2087
2088
2089
2090
2091
2092
2093
2094
2095
2096
2097
2098
2099
2100

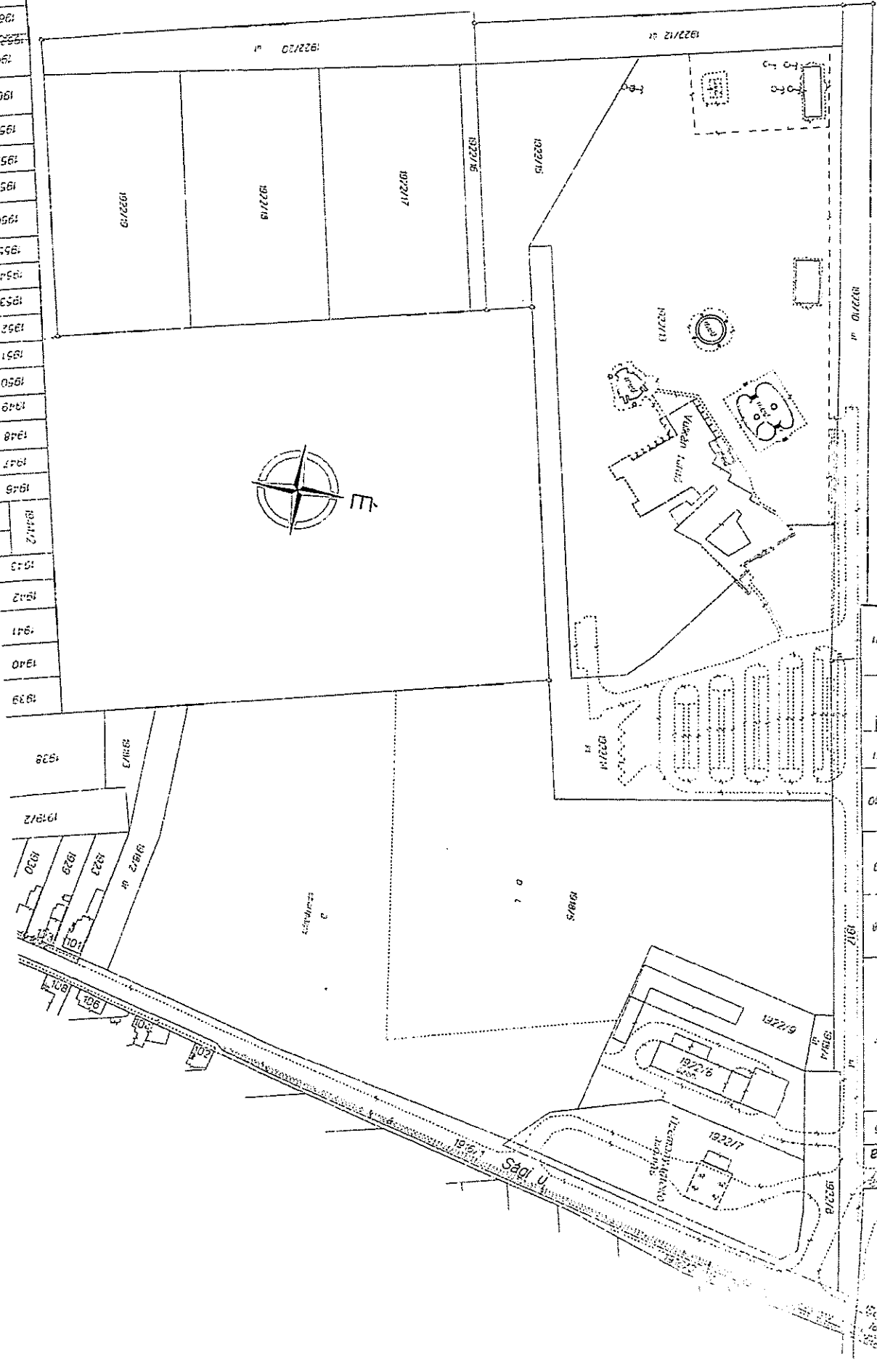

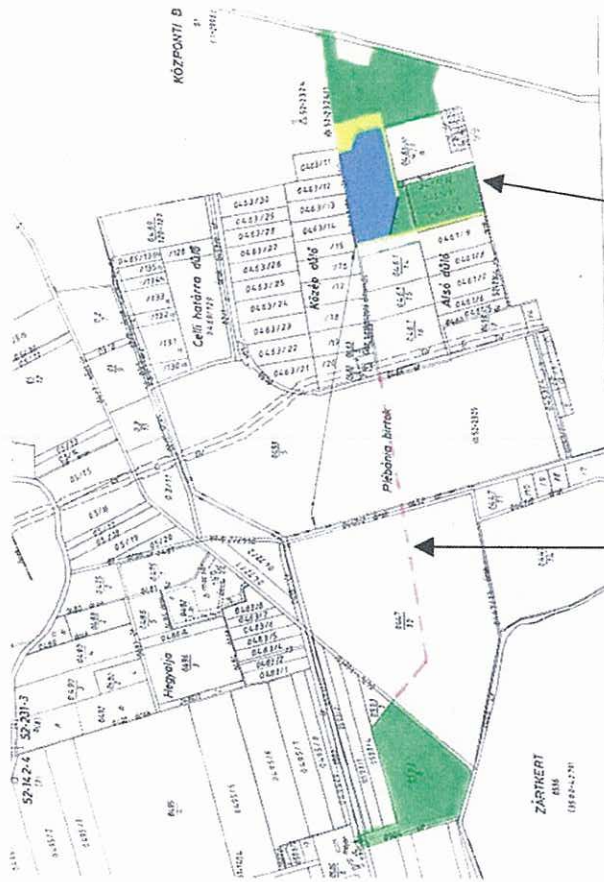

Volcano Spa 1st and 2nd phase

Planned by-pass